

Storm - PC

PC Dripper for Varied Field Conditions

Developed for agricultural applications, the Storm-PC emitter is designed for high performance even in sloped applications and extra-long laterals.

Advantages and Benefits

Pressure Compensating

Self-regulation ensures the same flow rate over a range of pressures, making it the ideal choice for sloped conditions or extra-long laterals in agricultural applications.

High Performance

Longer pipe runs with <0.05 emitting exponent giving a constant flow over a large pressure range

Ease of Use

Not sensitive to varied field conditions, such as slopes and valleys simplifying system design.

Self-Cleaning and Clog-Resistant

A self-cleaning silicone diaphragm and large cross-section labyrinth ensure compensation is not interrupted by suspended solids in the water.

Elevated Dual Filter

The elevated filters draw from faster moving water that is closer to the center of the pipe. The higher velocity helps keep the filter surface clean while the elevated filter entrance inhibits solids from settling on it between flow cycles, regardless of dripper orientation in the pipe.

Built-in Quality and Durability

Constructed with 100% premium virgin polyethylene and additives for resistance to UV degradation and damage caused from commonly used chemicals and fertilizers.

16mm Diameter available in 1.6, 2, and 4 LPH

18mm Diameter available in 2, and 4 LPH

Storm - PC

PC Dripper for Varied Field Conditions

Developed for agricultural applications, the Storm-PC emitter is designed for high performance even in sloped applications and extra-long laterals.

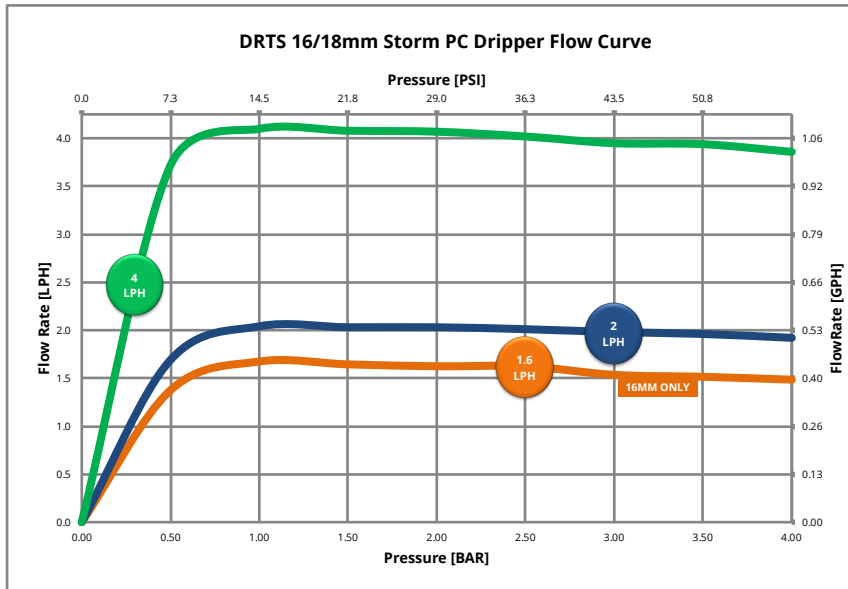

Flow Rate [L/h]	Diameter [mm]	CV @ 1 bar	Exponent	Starting Pressure	Max Pressure
1.6	16	< 5.3%	≤ 0.05	1.0 bar	4.0 Bar
2.0	16, 18	< 4.5%	≤ 0.05	1.0 bar	4.0 Bar
4.0	16, 18	< 4.3%	≤ 0.05	1.0 bar	4.0 Bar

Flow Rate [L/h]	0.5 bar	1 bar	1.5 bar	2 bar	2.5 bar	3 bar	3.5 bar	4 bar
1.6	1.38	1.68	1.65	1.63	1.63	1.54	1.52	1.49
2.0	1.69	2.04	2.03	2.03	2.01	1.98	1.96	1.92
4.0	3.72	4.10	4.08	4.07	4.02	3.95	3.94	3.86

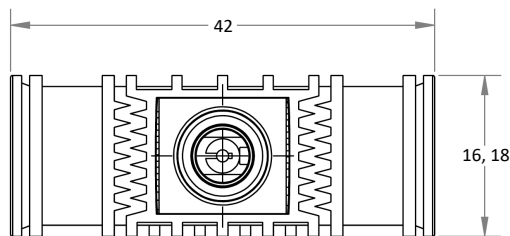

*Technical data is to be used as a guide only. Actual results may vary depending on manufactured pipe characteristics.



+1.858.587.4833

info@drts-corp.com

www.drts.com